



melvyn
Danes
ESTATE AGENTS



Yardley Wood Road
Yardley Wood
Offers Around £80,000

Description

Yardley Wood Road is in a convenient location for local shops. It is located off the main High Street, Solihull Lodge along which is Peterbrook Junior and Infant School and frequent bus services which provide access to the Maypole where a Sainsbury's supermarket and local shops are sited or, in the other direction to the A34 Stratford Road in the town centre of Shirley, passing by a number of shops and access to Shirley Railway Station from where commuter services operate to Birmingham and beyond.

There is easy access via the Maypole and Hollywood By-Pass to Junction 3 of the M42 motorway at Portway. The M42 forms the hub of the national motorway network and provides access, via the junction with the A45, to the National Exhibition Centre, National Motorcycle Museum, Birmingham International Airport and Railway Station.

An excellent location therefore for this purpose built, one bedroom first floor maisonette which is set back from the road behind a lawn foregarden and has the benefits of an allocated parking space and no upward chain. The property has approx 59 years remaining on the lease.



Accommodation

PORCH

HALLWAY

LOUNGE DINER

16'1" max x 12'5" max (4.90m max x 3.78m max)

KITCHEN

7'7" x 6'6" (2.31m x 1.98m)

BEDROOM

11'2" x 9'10" (3.40m x 3.00m)

BATHROOM

ALLOCATED PARKING SPACE



TENURE: We are advised that the property is leasehold with approx 59 years remaining. The service charge is approx £600 half yearly and the ground rent is £37.60 half yearly.

BROADBAND: We understand that the standard broadband download speed at the property is around 9 Mbps, however please note that results will vary depending on the time a speed test is carried out. The estimated fastest download speed currently achievable for the property post code area is around 2000 Mbps. Data taken from checker.ofcom.org.uk on 05/08/2025. Actual service availability at the property or speeds received may be different.

MOBILE: We understand that the property is likely to have/has limited current mobile coverage (data taken from checker.ofcom.org.uk on 05/08/2025). Please note that actual services available may be different depending on the particular circumstances, precise location and network outages.

VIEWING: By appointment only with the office on the number below.

These particulars are for general guidance only and are based on information supplied and approved by the seller. Complete accuracy cannot be guaranteed and may be subject to errors and/or omissions. They do not constitute representations of fact or form part of any offer or contract. Any Prospective Purchaser should obtain verification of all legal and factual matters and information from their Solicitor, Licensed Conveyancer or Surveyor as appropriate. The agent has not sought to verify the legal title of the property and the buyers must obtain verification from their solicitor. Photographs are provided for illustrative purposes only and the items shown in these are not necessarily included in the sale, unless specifically stated. The agent has not tested any apparatus, equipment, fixtures, fittings or services mentioned and do not by these Particulars or otherwise verify or warrant that they are in working order.

MONEY LAUNDERING REGULATIONS: Under anti-money laundering legislation, we are obliged to confirm the identity of individuals and companies and the beneficial owners of organisations and trusts before accepting new instructions, and to review this from time to time. To avoid the need to request detailed identity information from vendors and intending purchasers, we may use approved external services which review publicly available information on companies and individuals. However, should those checks, for any reason, fail adequately to confirm identity, we may write to you to ask for identification evidence. If you do not provide satisfactory evidence or information within a reasonable time, we may have to stop acting for you and we would ask for your co-operation in order that there will be no delay in agreeing a sale. Any purchaser who has a provisional offer accepted via this company will be liable to pay a purchase administration fee of £25 inclusive of VAT to cover these checks.

REFERRAL FEES: We may refer you to recommended providers of ancillary services such as Conveyancing, Financial Services and Surveying. We may receive a commission payment fee or other benefit (known as a referral fee) for recommending their services. You are not under any obligation to use the services of the recommended provider.

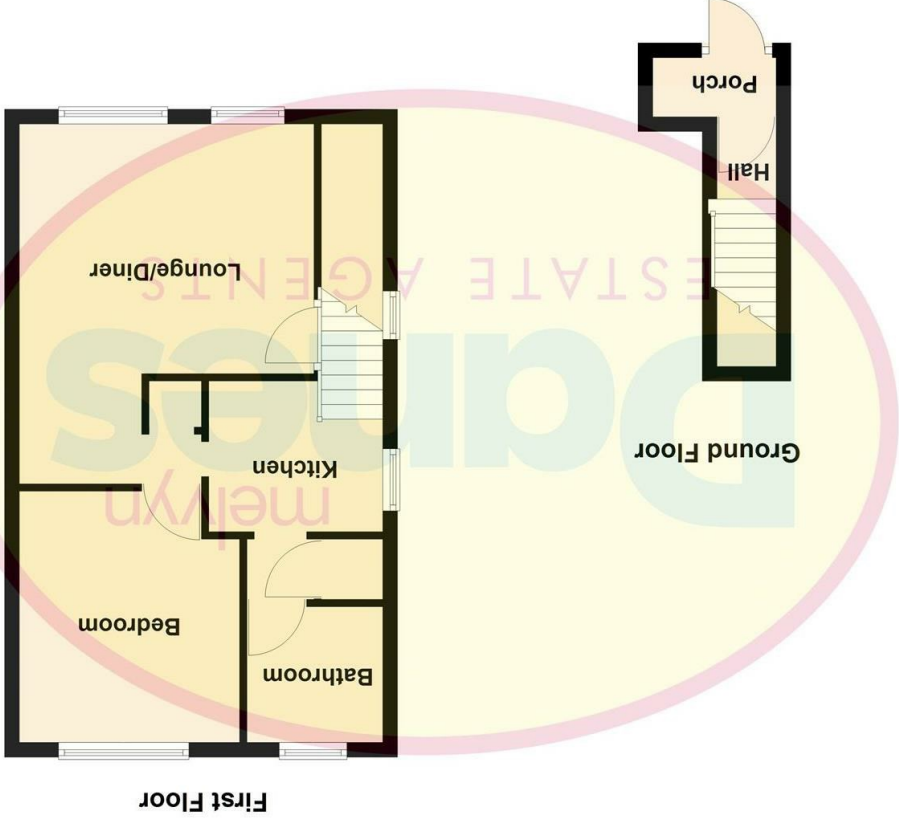
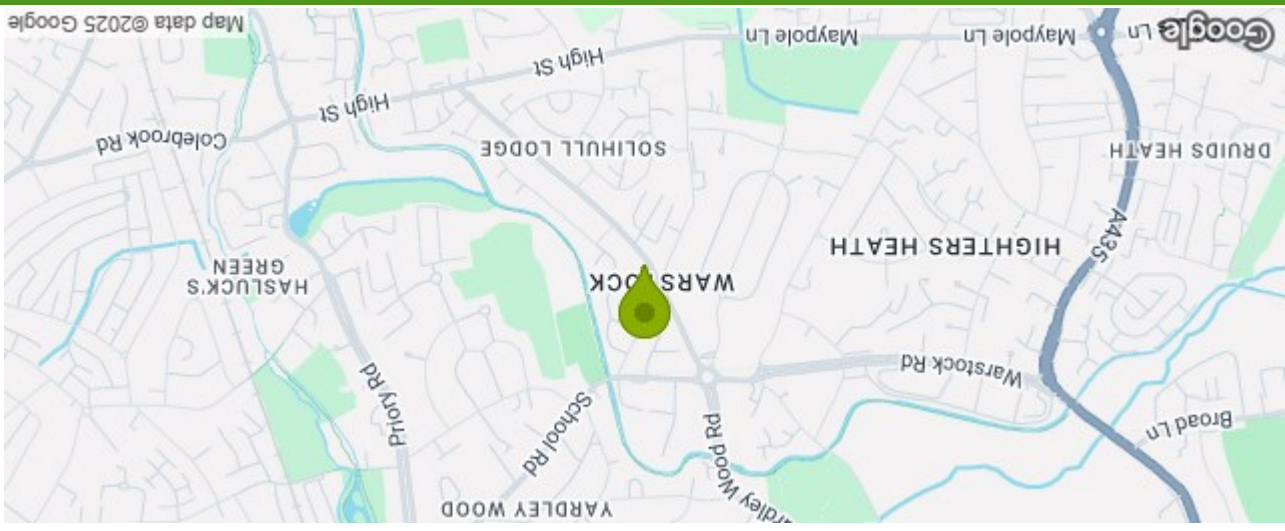

**1144 Yardley Wood Road Yardley Wood Birmingham B14 4LD
Council Tax Band: A**

Energy Efficiency Rating	
Very energy efficient - lower running costs	(92 plus)
A	(81-91)
B	(69-80)
C	(55-68)
D	(39-54)
E	(21-38)
F	(1-20)
G	
Not energy efficient - higher running costs	
EU Directive	2002/91/EC
England & Wales	
Current	Potential

Please note that all measurements and floor plans are approximate and quoted for general guidance only and whilst every attempt has been made to ensure accuracy, they must not be relied on and do not form part of any contract.